

# SNAP EDGE

SNAPEDGE  
 4-2300 SHIRLEY DRIVE,  
 KITCHENER, ON N2B 3Y2  
 TOLL FREE: 1-800-720-7627  
 PHONE: (519) 745-9996  
 FAX: (519) 745-8028  
 www.snapedge.ca

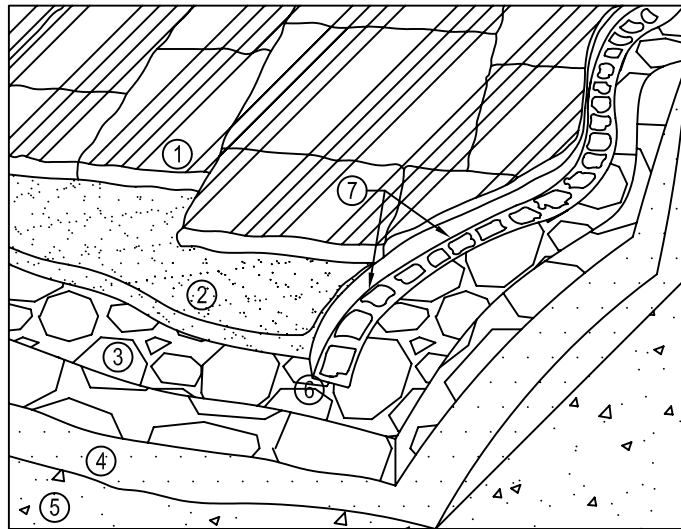

TYPICAL SEGMENTAL PAVER  
 INSTALLATION

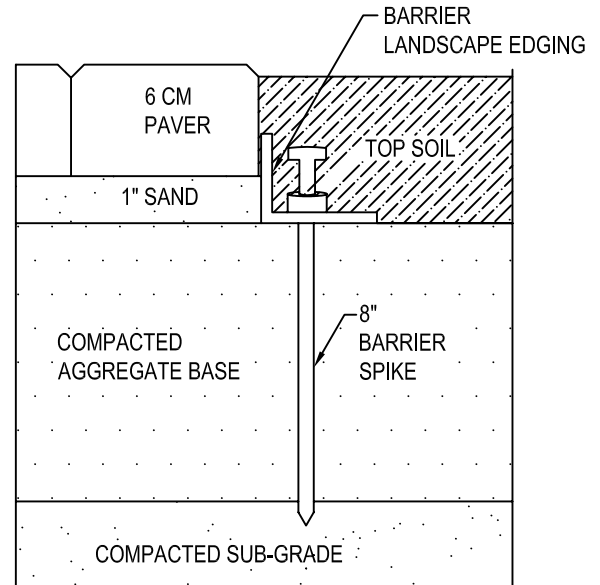

BARRIER INSTALLATION

LEGEND:

- ① PAVERS OR SLABS
- ② BEDDING SAND
- ③ COMPACTED AGGREGATE BASE
- ④ SEPARATION LANDSCAPE FABRIC
- ⑤ COMPACTED SOIL SUBGRADE
- ⑥ BARRIER™ EDGE RESTRAINT
- ⑦ 8"-10" LANDSCAPE SPIKES

NOTES:

1. INSTALLATION TO BE COMPLETED IN ACCORDANCE WITH MANUFACTURER'S SPECIFICATIONS.
2. ALL DIMENSIONS ARE CONSIDERED TRUE AND REFLECT MANUFACTURER'S SPECIFICATIONS.
3. DO NOT SCALE DRAWING.
4. THESE DRAWINGS ARE NOT FOR CONSTRUCTION PURPOSES AND ARE FOR INFORMATION PURPOSES ONLY. ALL INFORMATION CONTAINED HEREIN WAS CURRENT AT THE TIME OF DEVELOPMENT BUT MUST BE REVIEWED AND APPROVED BY THE PRODUCT MANUFACTURER TO BE CONSIDERED ACCURATE.
5. CONTRACTOR'S NOTE: FOR PRODUCT AND COMPANY INFORMATION VISIT [www.CADdetails.com/info](http://www.CADdetails.com/info) REFERENCE NUMBER 4801-004.

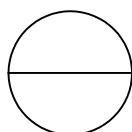

## PAVER EDGING

BARRIER PROFESSIONAL LANDSCAPE EDGE - 6' 8"